

## Fitting Instructions

### Bolted connectors for power cables

#### Product description

These bolted connectors are equipped with bolts, which shear off smoothly when the optimum contact force has been reached on tightening. They are used for joining the ends of cables with the same or different cross-section (see assignment table).

The scope of supply includes:

- 1 Bolted connector with shear bolts;
- Coloured centring sleeves (see table);
- Fitting instructions;
- Plastic covers for shear bolts (not supplied with all versions)

**⚠ Bolted connectors may only be fitted by qualified and trained specialist personnel. Fitting is to be carried out in clean and dry conditions. Read the fitting instructions carefully before fitting.**

PFISTERER Kontaktsysteme  
GmbH & Co. KG  
Rosenstrasse 44  
73650 Winterbach  
Germany  
Phone +49(0)71 81-70 05-0  
www.pfisterer.de

#### Fitting

##### Preparation of cable end

- Saw cable off evenly; do not cut.
- Remove outer sheath. The stripping length is to be chosen in accordance with the information provided by the joint box manufacturer.
- Cut to length the remaining layers, screens and insulation, with the exception of the primary insulation, in accordance with the joint box manufacturer's instructions.
- When removing the primary insulation and the conductor smoothing layer, the following dimensions apply:

Connector mm <sup>2</sup>	Stripping length L mm	
	with centring sleeve	without centring sleeve
25 - 150	60	55
50 - 240	69	67
95 - 300	76	73

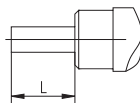

- We recommend cleaning aluminium cable ends shortly before placing in the conductor channel. The bare conductor must be clean and free from grease when fitting.

##### Preparing the bolted connector

- Centring sleeves must be used with smaller conductor sizes in order to ensure that the conductor is guided centrally (see assignment table). Fit the centring sleeve as far as the stop.

**⚠ The connector is pre-greased. Do not remove the grease.**

- Feed the stripped cable ends into the connector.
- Screw in the shear bolts evenly using an Allen key (width across flats, see assignment table) starting with

No. 1 until they break off smoothly. Continue with bolt No. 2 and similarly with the opposite side of the connector. (Tightening sequence see sketch).

Tightening sequence

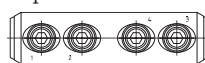

**The bolt must not protrude above the body of the connector after shearing. (Address the excess length if necessary).**

- If supplied, centre plastic covers over sheared-off bolts and press into place.

Pfisterer Kontaktsysteme GmbH & Co. KG is a reputable company, and is synonymous with high product quality. In order to continue to guarantee this quality, we depend on your feedback in the case of quality defects and fitting difficulties. Please inform us of any problems.

Pfisterer Kontaktsysteme GmbH & Co. KG shall not be liable in the case of improper use and non-observance of safety regulations, nor for consequential damages thereof.

We accept no liability for printing errors. Subject to technical change.

#### Assignment table for centring sleeves

	Designation Cross-section	332 593 001 25-150 mm <sup>2</sup>			332 592 001 50-240 mm <sup>2</sup>				332 602 001 95-300 mm <sup>2</sup>				
		SW 5 28 mm / 112 mm			SW 6 33 mm / 130 mm				SW 8 38 mm / 146 mm				
		Centring sleeve	grey	black	without	blue	black	white	without	blue	black	white	without
Round solid	Al Cu		25-70	95-120	150	50-95	95-150	185	240	95-150 95-120	185 150-185	240	300
Sector solid	Al Cu		90° 120°	25-70 25-50	95 70-95	120	50-70 95	120-150 120	185 150	95	120	150-185 150	240 185-240
Round stranded	Al Cu		25-50	70-95	120	50-70	95	120-150	185	95	120-150	185	240-300
Round stranded and compressed	Al Cu		25-70	95	120-150	50-70	95-120	150-185	240	95-120	150-185	240	300
Sector stranded	Al Cu		90° 120°	25-50 25-35	70 50	95 70-95	50 70	95-120 95	150 120-150		95	120-150 120	185-240 150-240